

ANGLED EXTRUSION + LED TAPELIGHT + MOTION SENSOR

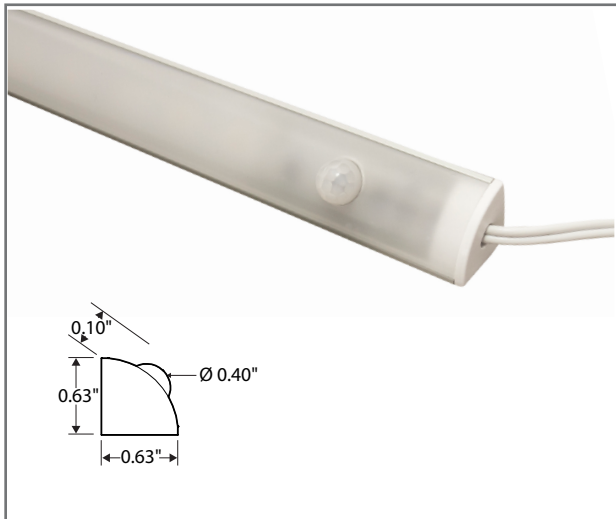

SPECIFICATIONS

FINISH	Silver Anodized, Black Powder Coat, White Powder Coat
LENS	Frosted, Clear, White
WATTAGE	1.5W/ft, 2.5W/ft, or 5.0W/ft
IP RATING	IP20 dry
CCT / COLOR	2200K - 5200K
BEAM SPREAD	114° typical with Frosted lens
INPUT VOLTAGE	24VDC
SENSOR	PIR on/off motion sensor, 120° detection angle, 118in range. shut-off delay 25 seconds, 3A max or 72W max @ 24V
LENGTH	Made to order. Actual lengths vary by LED tapelight cutpoints.
OUTPUT	155 to 393 lm/ft
LEDS	Single binned LEDs +/- 30-70 CCT, MacAdam 3 SDCM
MATERIAL	Extrusion - Anodized aluminum; Lens - Polycarbonate
MOUNTING	Mounting clips recommended
POWER SUPPLY	Requires a non-dim 24V power supply - see page 4
WARRANTY	IP20 - 5 year limited

5 YEAR LIMITED WARRANTY



FEATURES & RECOMMENDED APPLICATIONS

Surface-mount extrusion for corner applications. Curved lens increases beam appearance. Good for accent, under cabinet, displays, shelving, signage. Motion sensor can help to reduce operating costs for public areas.



PRODUCT: LLI-ANG-M-SF-T5.0W-30K-24V-48IN

ANGLED EXTRUSION + LED TAPELIGHT + MOTION SENSOR

ORDERING GUIDE

← PRODUCT CODE → OPTIONAL CODE →

PROFILE	SENSOR	1a. FINISH	1b. LENS	2. LED	3. IP RATING	4. CCT / COLOR	INPUT	5. LENGTH	6. MOUNTING	POWER FEED		
LLI-ANG	M	S	F	T2.5W	[blank]	30K	24V	48IN	[blank]	7. LEAD TYPE	8. LEAD LENGTH	9. FEED TYPE
	PIR motion sensor	Silver Black White	Frosted Clear White	1.5-5.0 W/ft	[blank] - IP20	Static White		Enter overall length in inches. Length can be a complete section (if under max run) or separated into smaller sections. Nominal length only. Actual lengths vary by LED cut point.	Default [blank] - Ships standard with standard clips. Refer to section 6 if you require alternate mounting.	Default [blank] - 48" hard wire end feed (PWR48EF) Refer to section 7 for an alternate power feed configuration.		

Example product code: LLI-ANG-M-SF-T2.5W-30K-24V-48IN

More LED tapelight and color options available upon request. Visit www.lliighting.com or contact us for details.

1. FINISH & LENS

1a. FINISH	1b. LENS
S	F

S Silver Anodized finish **F** Frosted lens
B Black Powder Coat finish **C** Clear lens
W White Powder Coat finish **W** White lens (special order)

2-4. LED TAPELIGHT OPTIONS

2. LED CODE	3. IP RATING*	4. CCT / COLOR	WATTAGE	DELIVERED LM/FT @ 30K^	FROSTED LENS APPEARANCE**	CRI	MAX. RUN	CUT POINTS*
T2.5W	[blank]	30K						
For IP20, leave [blank].								
T1.5W (White)	20	22K / 27K / 30K / 35K / 42K / 52K	1.5 W/ft	155 lm/ft	UNIFORM	90+	26 ft	1"
T2.5W (White)	20	22K / 27K / 30K / 35K / 42K / 52K	2.5 W/ft	204 lm/ft	UNIFORM	90+	20 ft	1"
CB4.6W (White COB)	20	27K / 30K / 35K / 40K	4.6 W/ft	346 lm/ft	UNIFORM	90+	16 ft	2"
T5.0W (White)	20	22K / 27K / 30K / 35K / 42K / 52K	5.0 W/ft	393 lm/ft	UNIFORM	90+	13 ft	1"

** Diode visibility data tested at 100% output. Diodes may become more visible as tapelight dims.
 ^ Lumen data based on frosted lens, IP20 tapelight, 3000K white output.
 * Protection varies according to IP Rating. See below or refer to lliighting.com/resources for more information.



IP20, uncoated - Dry Location

5. LENGTH

5. LENGTH

48IN

Enter overall extrusion length in inches. Maximum assembled length is 94in.
 Overall Extrusion+LED tapelight length will be rounded down based on nearest LED tapelight cut point.

6. MOUNTING (OPTIONAL)

6. MOUNTING

[blank]

Default [blank] - Standard Clip

ADJ Adjustable Clip

STANDARD MOUNTING CLIP INCLUDED UNLESS OTHERWISE SPECIFIED

ADJUSTABLE MOUNTING CLIP

0.66" W x 0.68" H x 0.56" L

1.4" W x 0.9" H x 1.4" L

7-9. POWER FEED (OPTIONAL)

7. LEAD TYPE 8. LEAD LENGTH 9. FEED TYPE

[blank] [blank] [blank]

Default [blank] - 48" hard wire end feed (PWR48EF)

Enter desired wire length in inches.

PWR Hard wire
MBC* Male barrel
FBC* Female barrel

EF End Feed
SR Right Side Feed
SL Left Side Feed

STANDARD 48" HARD WIRE END FEED INCLUDED UNLESS OTHERWISE SPECIFIED

End Feed (EF) - default Left Side Feed (SL) Right Side Feed (SR)

Hard wire, no connector - default (PWR)
 Male barrel connector (MBC)*
 Female barrel connector (FBC)*

ANGLED EXTRUSION + LED TAPELIGHT + MOTION SENSOR

WHAT'S INCLUDED

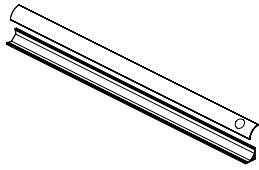

EXTRUSION WITH LENS

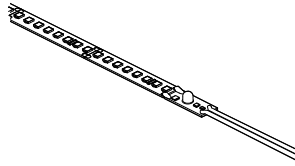

LED TAPELIGHT WITH MOTION SENSOR AND POWER FEED



ENDCAPS



MOUNTING CLIP

PIR MOTION SENSOR DETAIL

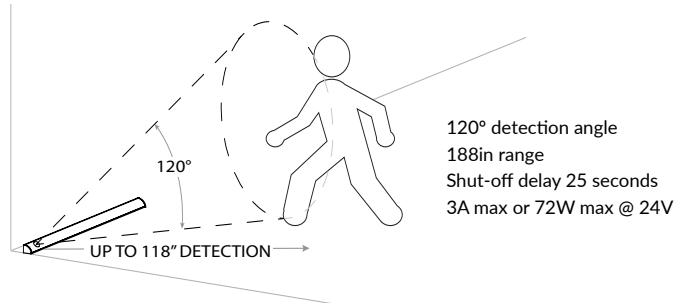
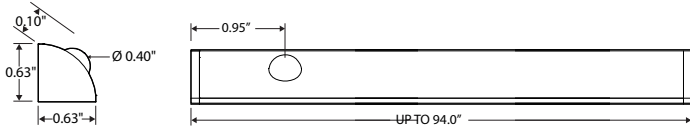

LUMEN OUTPUT MULTIPLIERS (FOR ESTIMATING DELIVERED LUMENS)

COLOR TEMPERATURE	LUMEN MULTIPLIER
2200K	0.8
2700K	0.9
3000K	1
3500K	1.1
4200K	1.2
5200K	1.25

FINISH	LUMEN MULTIPLIER
Silver Anodized	1
Black Anodized	0.9
White Powder Coat	1.1

EXAMPLE: White Powder Coat Extrusion, T2.5W, 5200K

(Output @ 30K) x (Color temperature lumen multiplier) x (Finish lumen multiplier) = Estimated delivered lm/ft

$$204 \text{ lm/ft} \times 1.25 \times 1.1 = 281 \text{ lm/ft}$$

PHOTOMETRY

LLI-ANG-O-SF-4.4W-30K-24V*	BEAM SPREAD	POLAR CHART	CONICAL CHART																															
<table border="1"> <tr> <td>POWER (W/ft)</td> <td>4.4W</td> </tr> <tr> <td>OUTPUT (lm/ft)</td> <td>293 lm/ft</td> </tr> <tr> <td>COLOR TEMPERATURE</td> <td>3000K</td> </tr> <tr> <td>BEAM SPREAD</td> <td>114°</td> </tr> <tr> <td>EFFICACY (lm/W)</td> <td>67 lm/W</td> </tr> </table>	POWER (W/ft)	4.4W	OUTPUT (lm/ft)	293 lm/ft	COLOR TEMPERATURE	3000K	BEAM SPREAD	114°	EFFICACY (lm/W)	67 lm/W	<p>114°</p>		<p>ILLUMINANCE AT A DISTANCE</p> <table border="1"> <tr> <th>Distance from light source</th> <th>Beam width</th> <th>Footcandles @ beam center</th> </tr> <tr> <td>1.7 ft</td> <td>5.2 ft</td> <td>13.9 fc</td> </tr> <tr> <td>3.3 ft</td> <td>10.1 ft</td> <td>3.7 fc</td> </tr> <tr> <td>5.0 ft</td> <td>15.4 ft</td> <td>1.6 fc</td> </tr> <tr> <td>6.7 ft</td> <td>20.6 ft</td> <td>0.9 fc</td> </tr> <tr> <td>8.3 ft</td> <td>25.5 ft</td> <td>0.6 fc</td> </tr> <tr> <td>10.0 ft</td> <td>30.8 ft</td> <td>0.4 fc</td> </tr> </table>	Distance from light source	Beam width	Footcandles @ beam center	1.7 ft	5.2 ft	13.9 fc	3.3 ft	10.1 ft	3.7 fc	5.0 ft	15.4 ft	1.6 fc	6.7 ft	20.6 ft	0.9 fc	8.3 ft	25.5 ft	0.6 fc	10.0 ft	30.8 ft	0.4 fc
POWER (W/ft)	4.4W																																	
OUTPUT (lm/ft)	293 lm/ft																																	
COLOR TEMPERATURE	3000K																																	
BEAM SPREAD	114°																																	
EFFICACY (lm/W)	67 lm/W																																	
Distance from light source	Beam width	Footcandles @ beam center																																
1.7 ft	5.2 ft	13.9 fc																																
3.3 ft	10.1 ft	3.7 fc																																
5.0 ft	15.4 ft	1.6 fc																																
6.7 ft	20.6 ft	0.9 fc																																
8.3 ft	25.5 ft	0.6 fc																																
10.0 ft	30.8 ft	0.4 fc																																

*Information for other options available upon request. IES files for extrusion+tapelight available upon request.

NON-DIMMABLE ELECTRONIC 

PART NUMBER	CAPACITY	INPUT	OUTPUT	CLASS	LOCATION	L	W	H
LLI-PS-NDE-030W-24V-KO	30W	100-277V	24V	CLASS 2	IP66 WET	6.5"	3.5"	1.02"
LLI-PS-NDE-060W-24V-KO	60W	100-277V	24V	CLASS 2	IP66 WET	7.4"	3.5"	1.2"
LLI-PS-NDE-096W-24V-KO	96W	100-277V	24V	CLASS 2	IP66 WET	8.7"	3.7"	1.7"
LLI-PS-NDE-200W-24V-KO	200W	100-277V	24V	CLASS 1	IP66 WET	10.3"	4.1"	1.8"
LLI-PS-NDE-300W-24V-KO	300W	100-277V	24V	CLASS 1	IP66 WET	10.9"	4.3"	1.8"

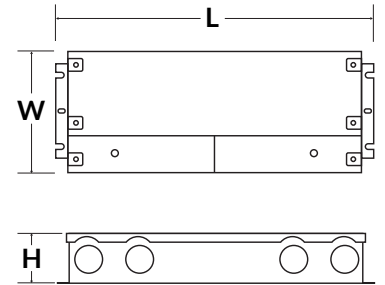

NON-DIMMABLE ELECTRONIC PLUG-IN 

PART NUMBER	CAPACITY	INPUT	OUTPUT	CLASS	LOCATION
LLI-PS-NDEP-006W-24V	6W	120V	24V	CLASS 2	IP20 DRY
LLI-PS-NDEP-012W-24V	12W	120V	24V	CLASS 2	IP20 DRY
LLI-PS-NDEP-036W-24V	36W	120V	24V	CLASS 2	IP20 DRY
LLI-PS-NDEP-072W-24V	72W	120V	24V	CLASS 2	IP20 DRY
LLI-PS-NDEP-096W-24V	96W	120V	24V	CLASS 2	IP20 DRY

6W, 12W, 36W

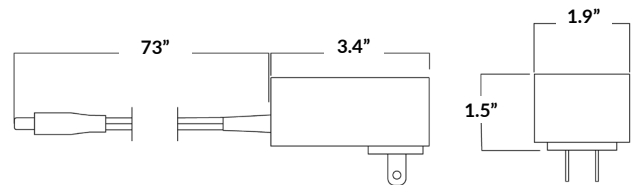

72W, 96W

