



SAFETY INFORMATION

- **WARNING:** These products may represent a potential shock or fire hazard if improperly installed or attached in any way. Products should be installed in accordance with these instructions, local electrical codes and the National Electric Code (NEC).
- Use only with 12V or 24V non-dimmable hardwire power supply. Factory warranty will be void if used otherwise.
- Do not use if there is any damage to the unit or to the wiring/insulation. Inspect periodically.
- Ensure wires are in compliance with local electrical codes.
- Controller is intended for indoor use in dry locations and not suitable for outdoor applications.
- Ensure proper gauge wires are installed between power supplies, controls and LED lighting to avoid voltage drop.
- Ambient temperature should not exceed 110°F or 50°C.
- Recommended load is 80% for optimal performance and lifespan.

DMX Certified Cable (by others/not included) is required for use between Decoders/Receivers and Controllers. The cable must be rated for electronic transmission. Standard solid/stranded building wire (THHN & others) will not work to transmit the DMX signal.

FUNCTION INTRODUCTION:

NOTES:

- This remote can control 3 zones. Each receiver can be paired with a maximum of 8 controllers.

Touch color wheel:
touch to select R/G/B color

Red channel: Click to turn off/on. Press and hold down to increase/decrease light intensity

Blue channel: Click to turn off/on. Press and hold down to increase/decrease light intensity

Click to select Warm White, Natural White and Cool White mixed by RGB colors

Press and hold down to increase/decrease light intensity

Green channel: Click to turn off/on. Press and hold down to increase/decrease light intensity

White channel: Click to turn off/on. Press and hold down to increase/decrease light intensity

Click to switch on/off

Click to play/pause the 10 built-in effects. Press and hold down to speed up/down the running effects

Zone Number:
Short touch 1. 2. 3. to choose the zone
Long touch 1. 2. 3. to switch on/off

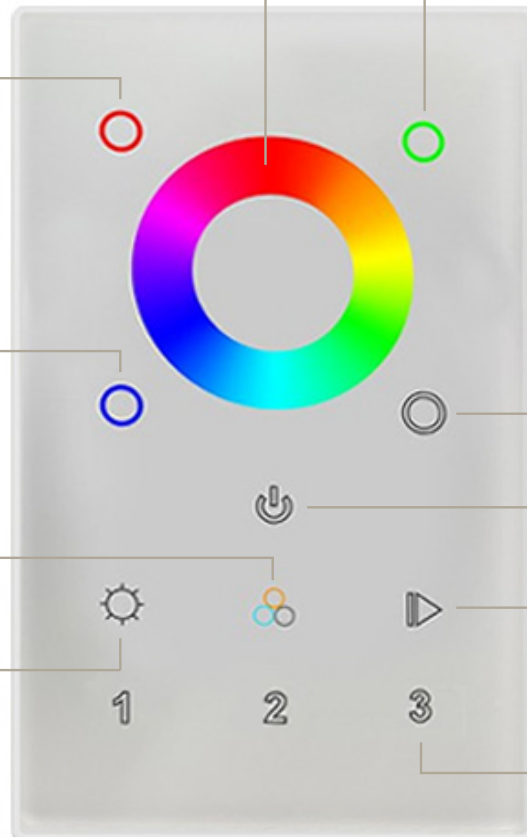

Installation

1

INSTALLATION NOTES:

- Review all parts and quantities to confirm if all necessary parts are available.

1.1 Separate the touch panel from the controller base by pulling on the tab at the top.

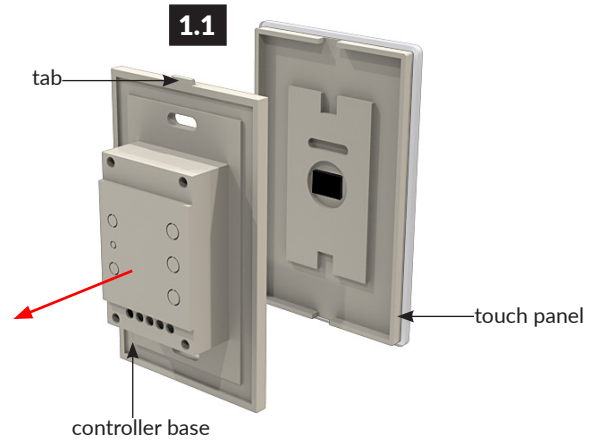

2

2.1 Connect power supply output wiring to wall mount controller. Ensure to connect to the proper polarity. Red (+), Black (-).

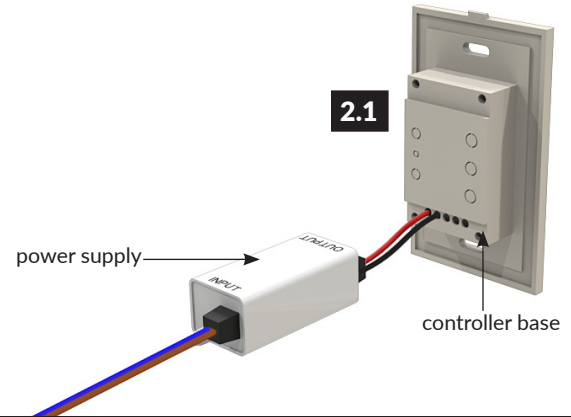

3

3.1 Connect the power supply input wiring to line voltage and place inside wall box.

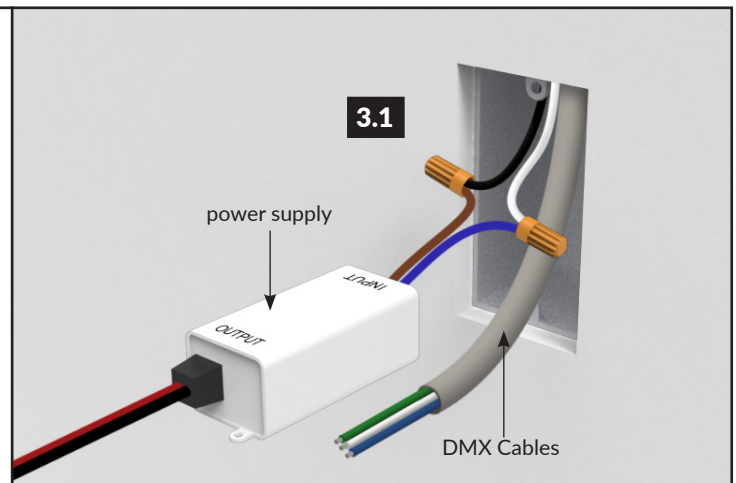

Installation

4

INSTALLATION NOTES:

- Must use communication cable for DMX data signal. Signal will not work when used with power cables. Cat5 twisted pair data cable is recommended.

4.1 Connect the DMX cables to the controller data input terminals. Use the green wire for GND, blue wire for D(-), white wire for D(+).

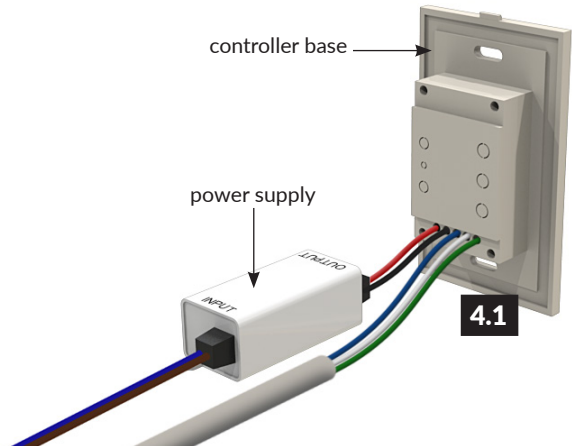

5

5.1 Secure wall mount controller base to wall box using screws provided.

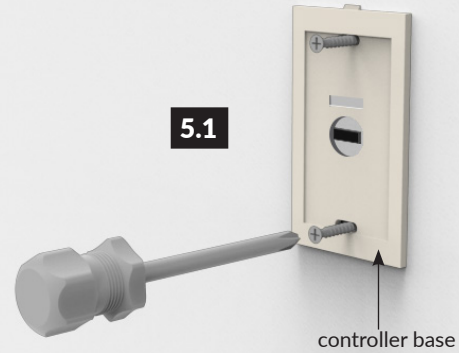

6

6.1 Attach touch panel to the controller base and turn power on to the unit.

6.2 3 zones can be controlled independently or together. Refer to DMX decoder installation instructions for more detail.



Wiring Diagram

