



## SAFETY INFORMATION

- **WARNING:** These products may represent a potential shock or fire hazard if improperly installed or attached in any way. Products should be installed in accordance with these instructions, local electrical codes and the National Electric Code (NEC).
- Use only with 12V or 24V non-dimmable hardwire power supply. Factory warranty will be void if used otherwise.
- Do not use if there is any damage to the unit or to the wiring/insulation. Inspect periodically.
- Ensure wires are in compliance with local electrical codes.
- Controller is intended for indoor use in dry locations and not suitable for outdoor applications.
- Ensure proper gauge wires are installed between power supplies, controls and LED lighting to avoid voltage drop.
- Ambient temperature should not exceed 110°F or 50°C.
- Recommended load is 80% for optimal performance and lifespan.

*DMX Certified Cable is required for use between Decoders/Receivers and Controllers. The cable must be rated for electronic transmission. Standard solid/stranded building wire (THHN & others) will not work to transmit the DMX signal.*

## FUNCTION INTRODUCTION:

**MODEL: LLI-C-CRTL-DMX-TW-TP**  
This remote can control 4 zones / receivers

Click to turn on/off

Click to switch to dual color control or brightness control

Press and hold down to save color; Click to recall saved colors

Z1

Z2

Z3

Z4

Total 4 zones, click to choose zone, Press and hold down to turn on/off corresponding zone

Brightness slider, touch to choose brightness

**MODEL: LLI-C-CRTL-DMX-TW-RT**  
This remote can control 1 zones / receivers

Rotary color wheel: turn knob to select color temperature

Push knob to switch on/off

## Installation

**1**

**INSTALLATION NOTES:**

- Review all parts and quantities to confirm if all necessary parts are available.

1.1 Separate the touch panel from the controller base by pulling on the tab at the top.

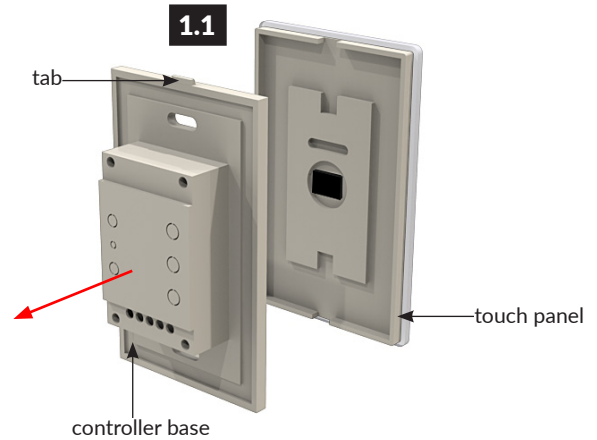

**2**

2.1 Connect power supply output wiring to wall mount controller. Ensure to connect to the proper polarity. Red (+), Black (-).

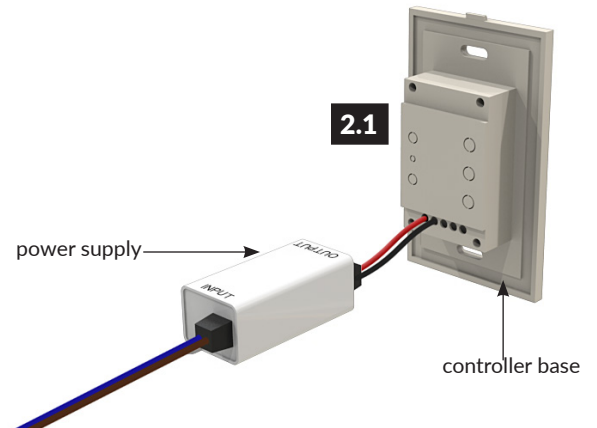

**3**

3.1 Connect the power supply input wiring to line voltage and place inside wall box.

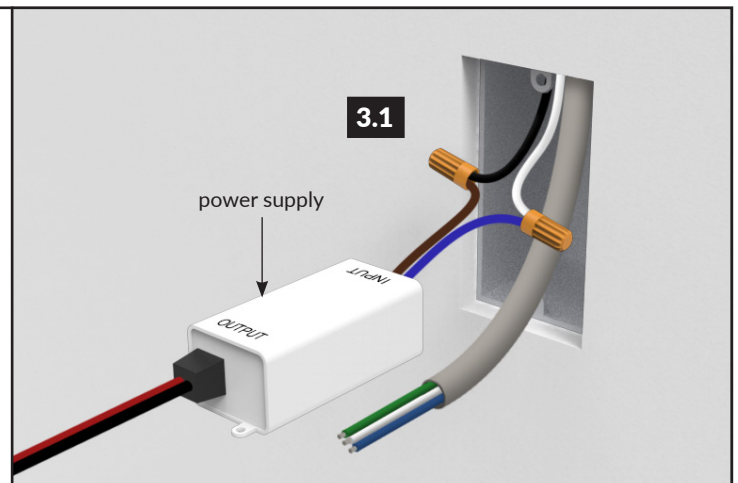

## Installation

**4**

**INSTALLATION NOTES:**

- Must use communication cable for DMX data signal. Signal will not work when used with power cables. Cat5 twisted pair data cable is recommended.

4.1 Connect data wires to controller data input terminals. Use green wire for GND, blue wire for D(-), white wire for D(+).

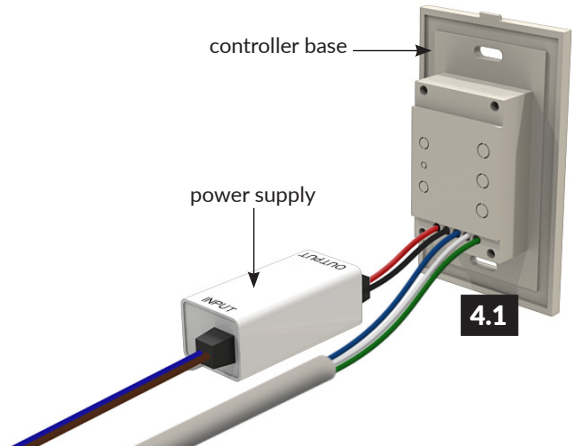

**5**

5.1 Secure wall mount controller base to wall box using screws provided.



**6**

6.1 Attach touch panel to the controller base and turn power on to the unit.

6.2 3 zones can be controlled independently or together. Refer to DMX decoder installation instructions for more detail.

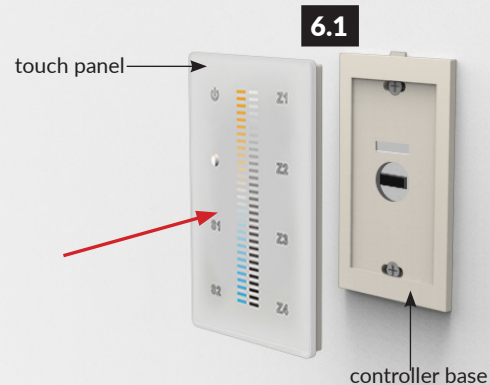

## Installation

### 7

7.1 Select the desired zone on your controller Z1 / Z2 / Z3 / Z4 and then slide your finger along the temperature slider until the LEDs respond to your control. If using the rotary dial, simply turn the knob until the LEDs respond to your control.

**INSTALLATION NOTES:**

- This step is not applicable for rotary dial controller. To save a desired setting on the controller press and hold S1 / S2 / S3 button until the indicator light flashes twice.

### 7.1



## Wiring Diagram

