



SAFETY INFORMATION

- **WARNING:** These products may represent a potential shock or fire hazard if improperly installed or attached in any way. Products should be installed in accordance with these instructions, local electrical codes and the National Electric Code (NEC).
- Use only with 12V or 24V non-dimmable hardwire power supply. Factory warranty will be void if used otherwise.
- Do not use if there is any damage to the unit or to the wiring/insulation. Inspect periodically.
- Ensure wires are in compliance with local electrical codes.
- Controller is intended for indoor use in dry locations and not suitable for outdoor applications.
- Ensure proper gauge wires are installed between power supplies, controls and LED lighting to avoid voltage drop.
- Ambient temperature should not exceed 110°F or 50°C.
- Recommended load is 80% for optimal performance and lifespan.

FUNCTION INTRODUCTION:

NOTES:

- This remote controls 4 zones/receivers. Each receiver can be paired with a maximum of 8 controllers.

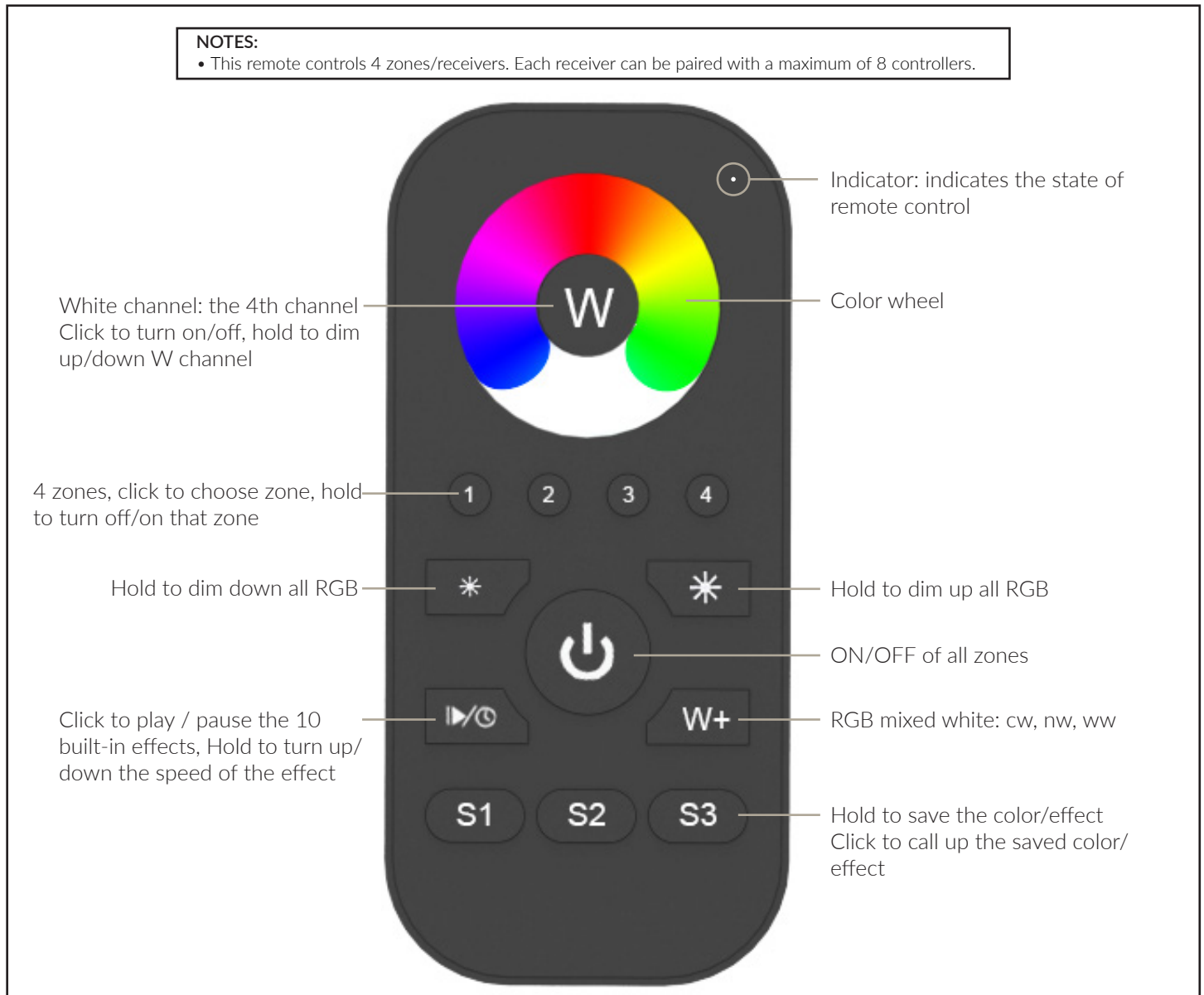

Installation: Pairing Controller with Receiver

1

1.1 Insert (3) AAA batteries into battery compartment and turn power on to your remote controller.

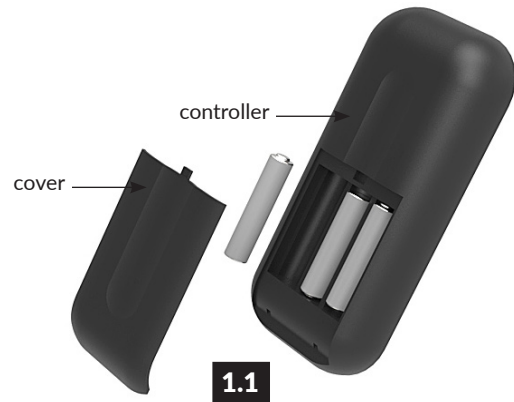

2

2.1 Once your controller is powered up, momentarily depress and release the learning key on the RF receiver.

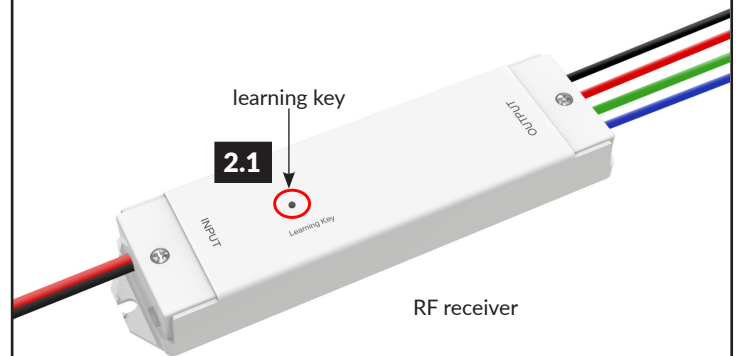

3

INSTALLATION NOTES:

- Repeat steps 2 & 3 for setting other zones/receivers as required.
- To delete a pairing press and hold the learning key for 3 seconds or until the LEDs blink twice.

3.1 Select the desired zone on your controller 1 / 2 / 3 / 4 and then rotate your finger around the control wheel until the LEDs respond to your control.

3.2 To save a desired setting on the controller press and hold S1 / S2 / S3 button until the indicator light flashes twice.



Wiring Diagram

