

# ELITE SURFACE EXTRUSION

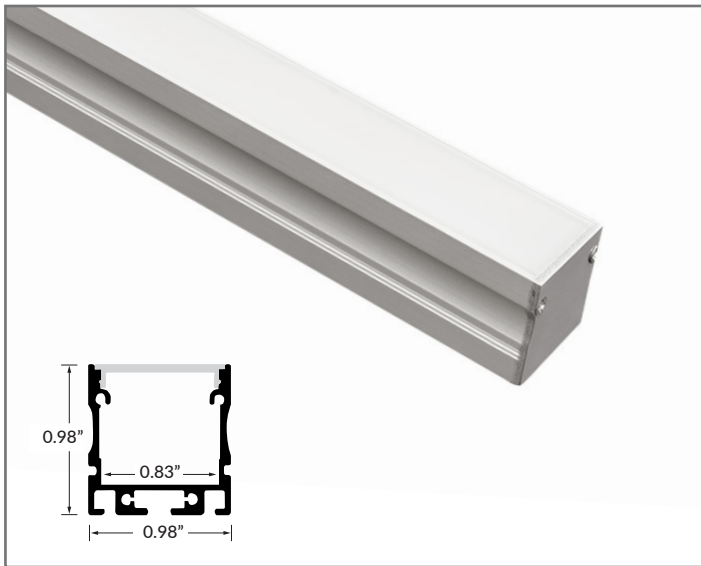

## QUICK SPECIFICATIONS

BODY MATERIAL	Double anodized aluminum
LENS MATERIAL	Polycarbonate
MAX. LED TAPE WIDTH	Accommodates tapes up to 0.83" wide
DIMENSIONS	0.98" W x 0.98 H

### FINISH

Standard finish is silver anodized.

Custom finishes available for any RAL #. Additional price and MOQ may apply.

### ACCESSORIES

Four (4) mounting clips included for each 48" or 94" section. Four (4) plastic endcaps included. Additional mounting clips and endcaps sold separately.

## PART NUMBER BUILDER / ORDERING GUIDE

Example part number: LLI-XS-ELT-SA-F-48IN

SERIES	FINISH	LENS	LENGTH
LLI-XS-ELT	SA	F	
	SA Silver Anodized	F Frosted	(enter custom length in inches, up to 94")
			48IN 48" section
			94IN 94" section

## ACCESSORIES

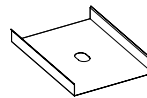

**MOUNTING CLIP**  
4 mounting clips included; extra clips sold separately

LLI-XS-ELT-MC

0.6"L x 1.0" W x 0.25" D



**ENDCAP**  
4 endcaps included; extra endcaps sold separately

LLI-XS-ELT-EC

Screws included

## FACTORY ASSEMBLED CORNERS (NO MITER CUTS REQUIRED. SCREWS AND JOINER BARS INCLUDED.)

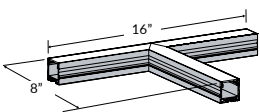

T CORNER

LLI-XS-ELT-SF-TEE-8IN

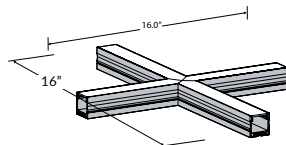

X CORNER

LLI-XS-ELT-SF-CROSS-8IN

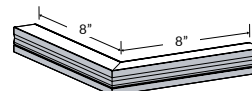

90° FLAT CORNER

LLI-XS-ELT-SF-90D-FLT-8IN

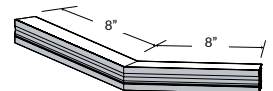

135° FLAT CORNER

LLI-XS-ELT-SF-135D-8IN

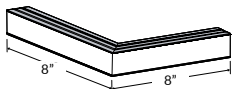

90° OUTSIDE CORNER

LLI-XS-ELT-SF-90D-OUT-8IN

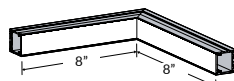

90° INSIDE CORNER

LLI-XS-ELT-SF-90D-INS-8IN